

February 2020, Monument Health will be replacing current collection systems for bacteria with COPAN eSwab™.



ESWAB™ INSTRUCTIONS

ESWAB™ IS EASY TO USE:

- Perform hand hygiene and put on gloves if necessary.
- Perform positive patient identification.
- Open the peel pouch.
- Remove the swab.
- Collect the patient sample using the swab. **Avoid touching the swab applicator below the pink molded breakpoint** as this could lead to contamination and incorrect test results.
- Remove the screw cap from the tube and insert the swab **all the way to the bottom of the tube**.
- Hold the tube away from your face. Holding the end of the swab shaft, bend it at a 180 degrees angle to break at the marked breakpoint. **If needed, gently twist the shaft between thumb and forefinger to completely remove it.**
- **Screw the cap on tightly to prevent leakage.**
- Dispose of the swab shaft in a regular trash receptacle.
- Apply patient identification label or write patient information on the tube label.
- Follow the standard operating procedures of transport and testing for your facility.
- Remove gloves if necessary and perform hand hygiene.

NOTE:

The eSwab Liquid Amies fluid maintains the viability of diverse bacteria. **Do not send a dry eSwab as this will lead to unsatisfactory results.**



eSwab™

MRSA SURVEILLANCE SAMPLE COLLECTION GUIDE



Peel Pouch Contents:



Flocked Swab



ESwab Tube



1) Perform hand hygiene.

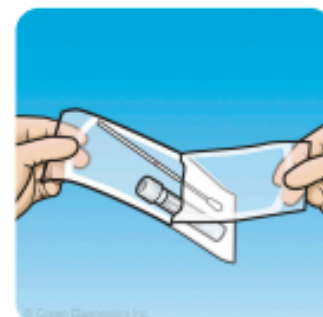

2) Open peel pouch.



3) Remove the swab and ESwab tube from the pouch.

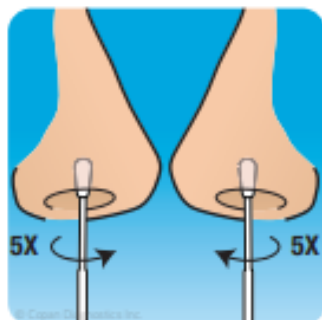

4) Place the swab into one of the patient's nostrils. Rotate 5 times, pressing lightly against the inside of the nose to collect the nasal sample. Repeat in second nostril with the same swab.



5) Open the ESwab tube and place the swab into the liquid.

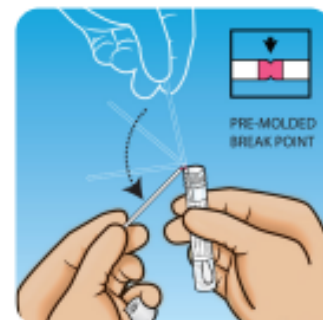

6) Hold the tube away from your face. Holding the end of the swab shaft, bend it at a 180 degrees angle to break at the marked breakpoint. If needed, gently twist the shaft between thumb and forefinger to completely remove it.



7) Dispose of the top of the swab stick in trash can.



8) Recap the ESwab tube, label with name and date.



9) Perform hand hygiene.

Step One



- **PEEL** open pouch and remove swab. Avoid touching the sterile area between the swab tip and breakpoint.
- Collect a small amount of stool by rotating and covering the swab tip with feces. **Do not use the swab as a tool to scoop sample into the tube.**

Step Two

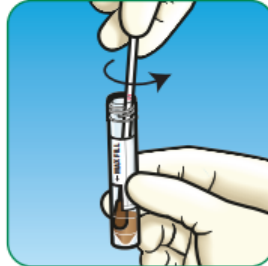

- **OPEN TUBE** and insert swab in tube. **DO NOT POUR OUT LIQUID. DO NOT EXCEED FILL LINE INDICATED ON THE TUBE LABEL.**
- **MASH AND MIX** stool specimen against the side of the tube to disperse specimen into the medium.

Step Three

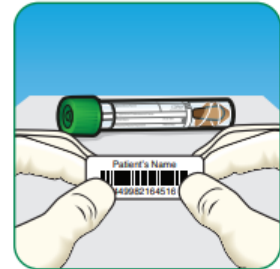
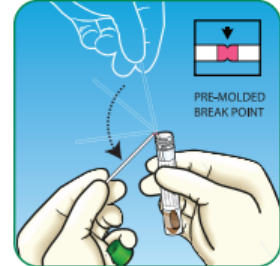

- Holding the tube away from your face **BEND AND TWIST** the swab applicator at visible molded breakpoint and discard the upper shaft.
- **TWIST** cap tube to tighten and shake until mixed.
- **LABEL** container with barcode. Avoid covering the **MAX FILL** line.

After collection, please store at room temperature (20 – 25°C) and deliver to the laboratory within 48 hours.